

## Low-Pressure Stationary Pump

### Description

The major components of the stationary pump in the 9960 and 9969 model series consist of a(n):

- air-operated motor
- double-acting reciprocating pump tube
- extension
- bung adapter (Models 9960, 9969-B, -M)
- drum cover assembly (Model 9960-A)

### Pump Assembly

The low-pressure (5:1 ratio) stripped pump included with the assembly is designed to deliver all grades of oil directly from their original containers.

#### Model 9960 and 9969 Series

Pump models 9960 and 9960-A include an extension to accommodate 16-gallon containers. Model 9960 has a stripped pump that includes a bung adapter while model 9960-A is equipped for attachment to a cover.

Models 9969-B and 9969-M\* include a stripped pump with a bung adapter and an extension to fit a 55-gallon (200/205 liter) container. See **Figure 1**.

\* The stripped pump included with model 9969-M includes an air motor inlet and a pump body outlet adapter with BSPT(P) threads.

### Specifications

*IMPORTANT: For detailed information on the pump tube (including specifications and performance data) refer to SER 9968.*

*For information on the motor, please refer to SER 339413.*

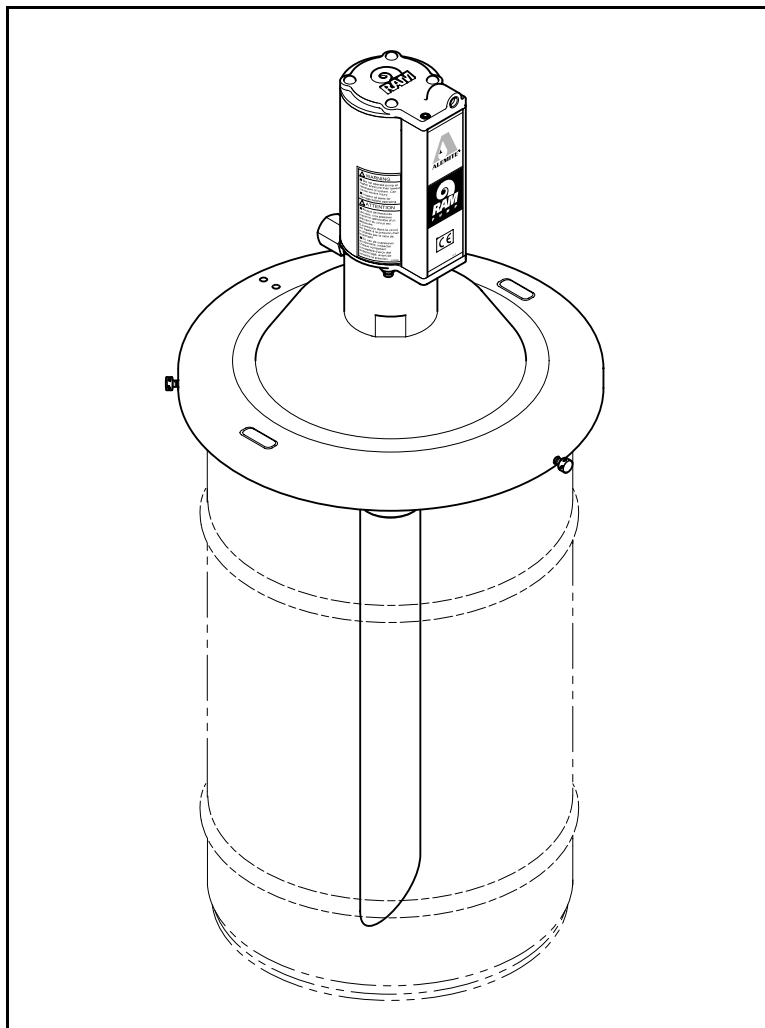

Stationary Pump Model	Container		Extension		Bung Adapter	Cover
	Gallons	Liters	Inches	Cm		
9960	16	-	21-3/4	55.2	●	
9960-A						●
9969-B	55	200/205	28-1/4	71.8	●	
9969-M *					●	

\* With Stripped Pump Equipped w/ BSPT(P) Thread Connection Components

**Figure 1** Stationary Pump Models 9960 and 9969 Series  
 Model 9960 -A Shown

Alemite, LLC

167 Roweland Drive, Johnson City, Tennessee 37601

www.alemite.com

Copyright © 2010 by Alemite, LLC

This document contains confidential information that is the property of Alemite, LLC and is not to be copied, used, or disclosed to others without express written permission.

SER 9960  
 Revision (7-10)

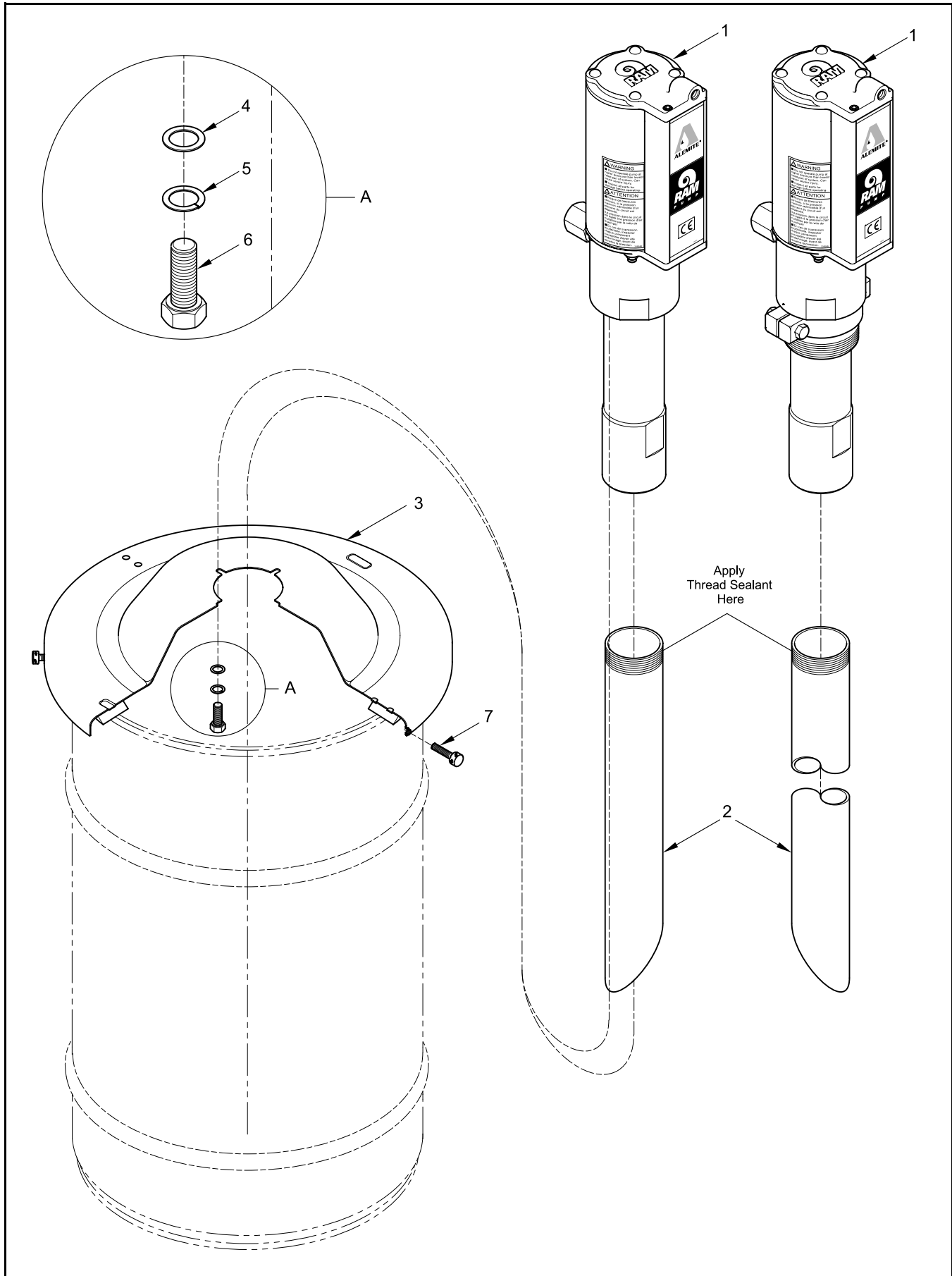

**Figure 2** Low-Pressure Stationary Pump Model 9960 and 9969 Series - Exploded View

Item No.	Part No.	Description	Qty	Stationary Pump Model				Notes	Numeric Order Part # (Item #)
				9960	9960-A	9969-B	9969-M		
1	9968	Pump, Stripped (w/ Bung Adapter)	1	●		●		See SER <b>9968</b>	9968 (1)
	9968-M	Pump, Stripped (w/ Bung Adapter) *	1				●		9968-A (1)
	9968-A	Pump, Stripped (w/o Bung Adapter)	1		●				9968-M (1)
2	338147-1	Extension, 21-3/4 " Long	1	●	●				<i>172207-1</i> (5)
	338147-2	Extension, 28-1/4 " Long	1			●	●		<i>17804</i> (4)
3	338145	Cover Assembly (w/ Gasket)	1		●				48018 (7)
4		Washer, 1/4 "	4		●			Included with item 3	<i>77786</i> (6)
5		Washer, Lock, 1/4 "	4		●				338145 (3)
6		Capscrew, 1/4 " -20 x 1/2 "	4		●				338147-1 (2)
7	48018	Screw, Thumb, 1/4 " -28	3		●				338147-2 (2)
<b>Legend:</b> Part numbers left blank (or in <i>italics</i> ) are not available separately * With BSPT(P) Thread Connection Components									

## Assembly

**NOTE:** Refer to **Figure 2** for component identification on all assembly procedures.

### CAUTION

**Select a clean environment for all assembly procedures. Prevent contamination from foreign material. Damage to components can occur.**

#### Pump Assembly

*IMPORTANT: Make sure to remove the protective cover from the inlet of Pump Assembly (1).*

*Do not apply thread sealant to the first two (2) threads of any connection. Contamination can occur.*

- Screw Extension (2) [with thread sealant] into the foot valve of the Pump Assembly.
  - Tighten the Extension securely.

#### Steps for Model 9960-A Only

- Install the Pump Assembly into Cover (3).
- Secure the Pump Assembly to the Cover with Washers (4), Lock Washers (5), and Capscrews (6).
  - Tighten the Capscrews securely in a crisscross pattern.
- Fit the pump and cover assembly onto the container.
- Secure the Cover to the container with Thumb Screws (7).

#### Changes Since Last Printing

Correction: "Low" pressure was "Medium"

